

ČESKÁ REPUBLIKA  
CZECH REPUBLIC

ŘÍZENÍ LETOVÉHO PROVOZU ČR, s.p.  
Letecká informační služba  
AIR NAVIGATION SERVICES OF THE C.R.  
Aeronautical Information Service

Navigační 787  
252 61 Jeneč

AIP SUP

2/17

PUBLICATION DATE: 16 FEB 17

+420 220 372 825  
+420 220 372 702  
ais@ans.cz  
<http://lis.rlp.cz>

**Praha/Ruzyně (LKPR) - Uzavření RWY 12/30**

**Praha/Ruzyně (LKPR) - RWY 12/30 closure**

- Účinnost/Effectivity: od/from: **15 MAR 17 0700 UTC**  
do/to: **31 MAY 17 1200 UTC**
- Část AIP, které se tento AIP SUP týká/AIP section affected by this AIP SUP: **AD 2**
- Proveďte záznam na straně/Record the AIP SUP on page **GEN 0.3**
- Následující publikace jsou zahrnuty do tohoto AIP SUP a tím zrušeny:  
The following publications have been incorporated in this AIP SUP and therefore cancelled:  
**AIP SUP: NIL**  
**AIC: NIL**  
Následující NOTAMy jsou zahrnuty do tohoto AIP SUP a budou zrušeny NOTAMem:  
The following NOTAMs are incorporated in this AIP SUP. They will be cancelled by NOTAM.  
**NOTAM: NIL**

1 V termínu od 15 MAR 17 0700 UTC do 31 MAY 17 1200 UTC bude RWY 12/30 uzavřena pro vzlety a přistání.

2 Společně s RWY 12/30 budou uzavřeny TWY:

- TWY G mezi RWY 12/30 a TWY F;
- TWY P mezi RWY 12/30 a TWY L;
- TWY R mezi RWY 12/30 a TWY L;
- TWY L mezi THR 30 a TWY S;

3 V termínu od 15 MAR 17 0700 UTC do 24 MAY 17 1400 UTC budou uzavřeny:

- TWY F mezi TWY D a TWY L;
- TWY G mezi TWY F a TWY L;

4 V termínu od 24 MAY 17 1400 UTC do 31 MAY 17 1200 UTC bude uzavřena:

- TWY D mezi TWY F a TWY L;

5 Denní a noční značení dle EASA (European Aviation Safety Agency) Certification Specification.

1 From 15 MAR 17 0700 UTC to 31 MAY 17 1200 UTC, RWY 12/30 will be closed for take offs and landings.

2 Following TWY will be closed together with RWY 12/30:

- TWY G between RWY 12/30 and TWY F;
- TWY P between RWY 12/30 and TWY L;
- TWY R between RWY 12/30 and TWY L;
- TWY L between THR 30 and TWY S;

3 From 15 MAR 17 0700 UTC to 24 MAY 17 1400 UTC will be closed:

- TWY F between TWY D and TWY L;
- TWY G between TWY F and TWY L;

4 From 24 MAY 17 1400 UTC to 31 MAY 17 1200 UTC will be closed:

- TWY D between TWY F and TWY L;

5 Day and night marking according to EASA (European Aviation Safety Agency) Certification Specification.

KONEC

END

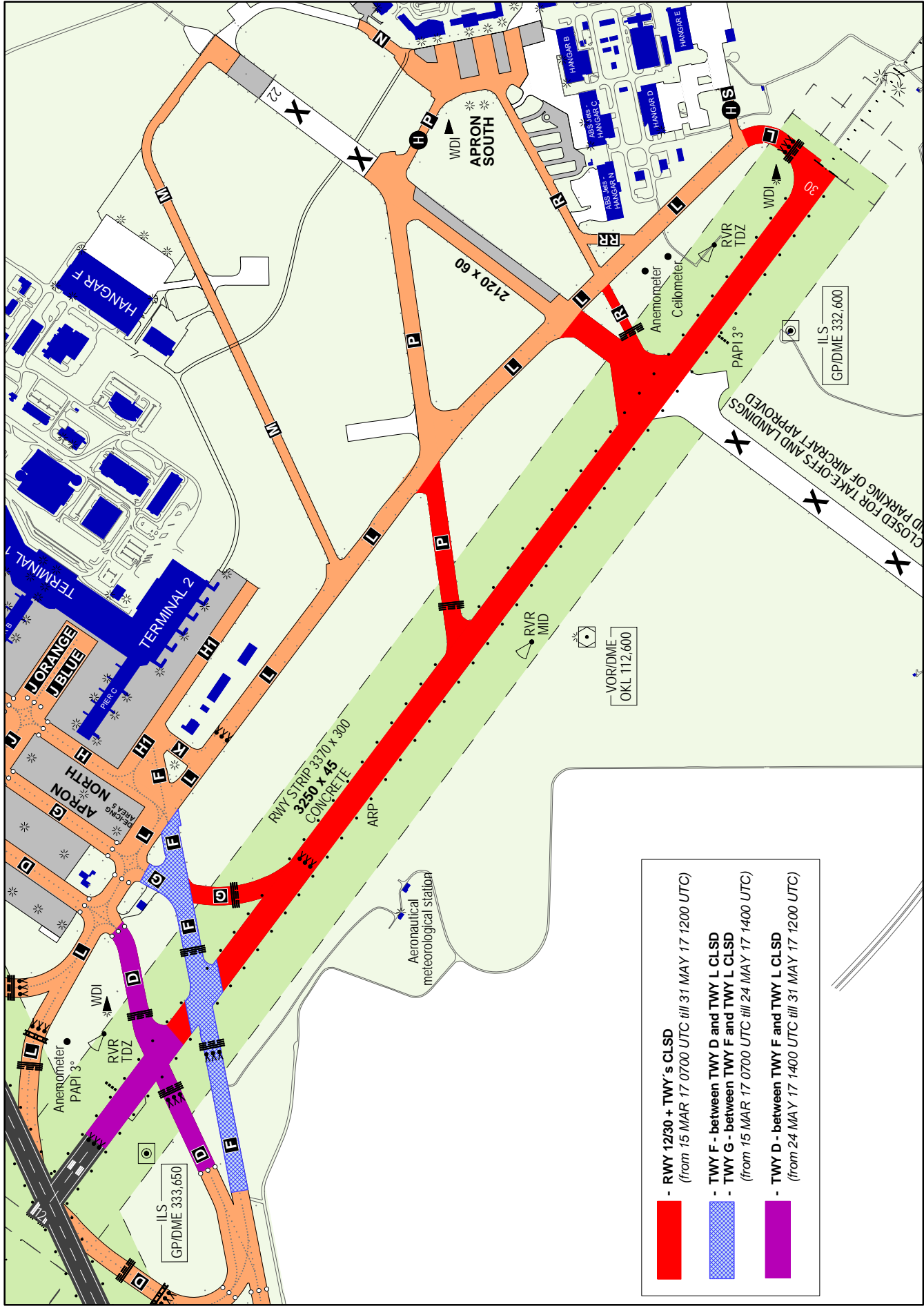

- RWY 12/30 + TWY's CLSD  
(from 15 MAR 17 0700 UTC till 31 MAY 17 1200 UTC)
- TWY F - between TWY D and TWY L CLSD  
- TWY G - between TWY F and TWY L CLSD  
(from 15 MAR 17 0700 UTC till 24 MAY 17 1400 UTC)
- TWY D - between TWY F and TWY L CLSD  
(from 24 MAY 17 1400 UTC till 31 MAY 17 1200 UTC)