

ČESKÁ REPUBLIKA
CZECH REPUBLIC





ŘÍZENÍ LETOVÉHO PROVOZU ČR, s.p.
Letecká informační služba
AIR NAVIGATION SERVICES OF THE C.R.
Aeronautical Information Service

Navigační 787
252 61 Jeneč

AIP SUP

31/17

PUBLICATION DATE: **27 SEP 17**

 +420 220 372 825
 +420 220 372 702
 ais@ans.cz
 <http://lis.rlp.cz>

Praha/Ruzyně (LKPR) - Uzavření RWY 12/30

Praha/Ruzyne (LKPR) - RWY 12/30 closure

- Účinnost/Effectivity: od/from: **30 OCT 17 0700 UTC**
do/to: **3 NOV 17 1400 UTC**
- Část AIP, které se tento AIP SUP týká/AIP section affected by this AIP SUP: **AD 2**
- Proveďte záznam na straně/Record the AIP SUP on page **GEN 0.3**
- Následující publikace jsou zahrnuty do tohoto AIP SUP a tím zrušeny:
The following publications have been incorporated in this AIP SUP and therefore cancelled:
AIP SUP: NIL
AIC: NIL
Následující NOTAMy jsou zahrnuty do tohoto AIP SUP a budou zrušeny NOTAMem:
The following NOTAMs are incorporated in this AIP SUP. They will be cancelled by NOTAM.
NOTAM: NIL

- | | | | |
|---|---|---|--|
| 1 | V termínu od 30 OCT 17 0700 UTC do 3 NOV 17 1400 UTC bude RWY 12/30 uzavřena pro vzlety a přistání. | 1 | From 30 OCT 17 0700 UTC to 3 NOV 17 1400 UTC, RWY 12/30 will be closed for take offs and landings. |
| 2 | Společně s RWY 12/30 budou uzavřeny TWY:
- TWY G mezi RWY 12/30 a TWY F;
- TWY P mezi RWY 12/30 a TWY L;
- TWY R mezi RWY 12/30 a TWY L;
- TWY L mezi THR 30 a TWY S; | 2 | Following TWY will be closed together with RWY 12/30:
- TWY G between RWY 12/30 and TWY F;
- TWY P between RWY 12/30 and TWY L;
- TWY R between RWY 12/30 and TWY L;
- TWY L between THR 30 and TWY S; |
| 3 | V termínu od 2 NOV 17 0700 UTC do 3 NOV 17 1400 UTC bude uzavřena:
- TWY D mezi TWY F a TWY L; | 3 | From 2 NOV 17 0700 UTC to 3 NOV 17 1400 UTC will be closed:
- TWY D between TWY F and TWY L; |
| 4 | ILS RWY 12 / DME PG (FREQ 109,50 MHz) mimo provoz. | 4 | ILS RWY 12 / DME PG (FREQ 109,50 MHz) out of order. |
| 5 | ILS RWY 30 / DME PA (FREQ 109,95 MHz) mimo provoz. | 5 | ILS RWY 30 / DME PA (FREQ 109,95 MHz) out of order. |
| 6 | Denní a noční značení dle EASA CS-ADR-DSN. | 6 | Day and night marking according to EASA CS-ADR-DSN. |

—————KONEC—————

—————END—————

FROM 30 OCT 2017 0700 UTC TILL 3 NOV 2017 1400 UTC - RWY 12/30 CLOSED
 FROM 2 NOV 2017 0700 UTC TILL 3 NOV 2017 1400 UTC - TWY D BETWEEN TWY F AND TWY L CLOSED

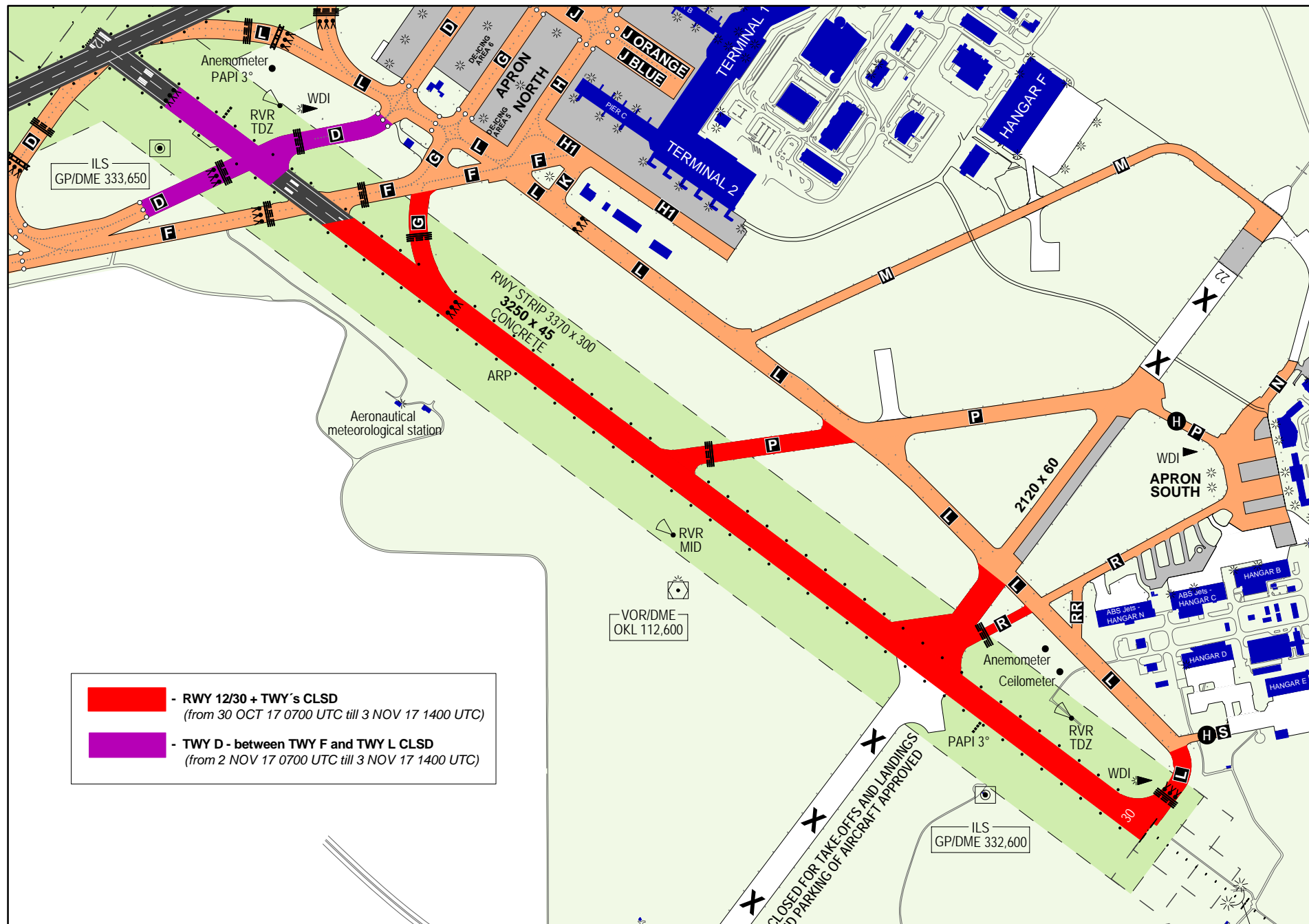

Red Area: - RWY 12/30 + TWY's CLSD
 (from 30 OCT 17 0700 UTC till 3 NOV 17 1400 UTC)

Purple Area: - TWY D - between TWY F and TWY L CLSD
 (from 2 NOV 17 0700 UTC till 3 NOV 17 1400 UTC)

CLOSED FOR TAKE-OFFS AND LANDINGS
 AND PARKING OF AIRCRAFT APPROVED